

4WD HUBS APPLICATIONS

CHEVROLET/ GMC	Year	Cautionary Footnotes	Spline Count	Standard Manual PN	Premium Manual PN	Spindle Nut Kit Std/Prem	Hub Service Kit Std	Prem
Blazer, Jimmy, Suburban	'69±91	G, H	19	9790	20990	32720	11967	20825
1/2 Ton Pickup	'69±87	G, H	19	9790	20990	32720	11967	20825
3/4 Ton Pickup	'60±76	G	19		9072			7302
3/4 Ton Pickup	'77±87	G, H	19	9790	20990	32720	11967	20825
1 Ton Pickup	'76±87	H	30	11690	38826	32721	11714	
1 Ton Pickup, V-Series Crew Cab	'88±90	H	30	11690	38826	32721	11714	
Geo Tracker	'89±00	J	26	39198	34581			7309

DODGE

1/2 Ton Pickup	'57±68		19		9072			7302
1/2 Ton Pickup & Ramcharger	'69±74		19	9790	20990		11967	20825
1/2, 3/4 Ton Pickup & Ramcharger	'80±93		19	9790	20990		11967	20825
3/4 Ton Pickup	'90±93		30	11690	38826		11714	
3/4 Ton Pickup	'57±74		19		9072			7302
1 Ton Pickup	'90±93		30	11690	38826		11714	

FORD

Bronco II, Ranger	'83±89	E, D	23	29070		27988	39128	
Explorer	'90±94	D, E	27	29071		32720	39128	
Ranger	'90±97	E, D	27	29071		32720	39128	
Bronco	'66±96	B, G, H	19	9790	20990	32720	11967	20825
1/2 Ton Pickup	'59±96	B, G, H	19	9790	20990	32720	11967	20825
3/4 Ton Pickup	'59±75		19	9790	20990		11967	20825
3/4 Ton Pickup, Light Duty	'77.5±97	H	19	9790	20990	32720	11967	20825
3/4 Ton Pickup, Heavy Duty	'63±77	G	19		9072			7302
3/4 Ton Pickup, Crew Cab only	'76±77.5		19		29063			7302
3/4 Ton Pickup, Heavy Duty	'78±97	H	30	11690	38826	32721	11714	11714
1 Ton Pickup	'78±97	H	30	11690	38826	32721	11714	11714
Super Duty	'99±	K	30	11690	38826		11714	11714
Courier, Ranger Int'l only	'99±01		26	61572				

INTERNATIONAL HARVESTER

Scout	'61±70		10		29062			7300
Scout II, Terra, Traveler	'71±80		27		9062			7300
1/2 Ton Pickup, Travelall	'68±75		19	9790	20990		11967	20825
1/2 Ton, 3/4 Ton Pickup	'56±72		19		9072			7302

ISUZU

Trooper I	'83±86		24		61424			61692
Trooper II	'87±93		17		61385			61693

JEEP

CJ, Universal, M88A1, Willys	'71 & Prior	A	10		29062			7300
CJ, Universal (6 bdt)	'72±80	G	27		9062			7300
CJ, Universal Scrambler (5 bdt)	'81±86	F	27	28751				
Jeepster C101 Commando	'66±71		10		29062			7300
Jeepster C104	'72±73		27		9062			7300
Gladiator, Wagoneer, Pickup	'73 & Prior		10		29062			7300
Full size Wagoneer, Cherokee								
J-10 Pickup, Commander	'74±91	G	19	9790	20990		11967	20825
J-20 Pickup (heavy axle)	'72±76		19		9072			7302
J-20 Pickup	'77±87		19	9790	20990		11967	20825
J4800 Pickup, Camper Spl.	'69±74		10		6094			7302
Jeep Station Wagon, Pickup	'65 & Prior		10		29062			7300
Sidekick, X-90, Vitara, Escudo	'89±01	J	26	39198	34581			7309
Hilux Int'l with Torsion bar susp.	'98±01	C			28761	29918		7309

Cautionary Footnotes:

- A Very early vehicles may require that the threaded axle end be cut off.
- B Will not fit '87-early '88 model vehicles, flange mount. (Dealer item only. See Ford parts & service).
- D Very early '90 vehicles with 23 tooth axle spline require 1989 model hubs.
- E When replacing factory automatic hubs with manual hubs, you must also purchase Spindle Nut Conversion Kit #27988 for '83-'89 vehicles; Conversion Kit #32720 for '90-'97.
- F Will not fit vehicles with factory optional chrome wheels.
- G Vehicles with full-time 4WD will require a transfer case conversion kit.
- H When replacing automatic 3 hole cap screw hubs with manual hubs, you must purchase corresponding spindle nut conversion kit per application chart.
- J Not for front axle disconnect systems.
- K Will not fit dual wheel application

4WD HUBS APPLICATIONS

Year	Cautionary Footnotes	Spline Count	Standard Manual PN	Premium Manual PN	Spindle Nut Kit Std/Prem	Hub Service Kit Std	Prem
MAZDA							
Spportage, Retona	'95±01		26	60247			
Spportage, Retona	'95±01		26				Automatic Locking Hubs 61918
NISSAN							
Pickup	'94±97	E	27	29071		32720	
Blap	'90±94	E	27	29071		32720	
B Series, Fighter, Int'l only	'99-01		26	61572			
SUZUK							
Samurai, Sierra	'82±01	J	26		34581		7309
Sidekick, X-90, Vitara, Escudo	'89±01	J	26	39198	34581		7309

4WD MANUAL HUBS WARRANTY

Warranty manual hubs carry a lifetime limited warranty. Dealers, Distributors, Warn Industries Service Centers and Factory Hub Service Department honor the warranty according to the terms and conditions specified in the W ARN Hubs Limited Warranty. The warranty is printed on every hub Installation Instruction Sheet.

TOYOTA

Pickup, Hilux, 4-Runner, with ADD	'86±95	C	26		28761	29918	7309
Landcruiser	'63±75		6		28781		7309
Landcruiser	'76±87	C	30		28771	29918	7309
Pickup, Hilux, 4-Runner	'76±85	C	30		28771	29918	7309
T100	'93±99	C	26		28761	29918	7309
T100, WADD	'93±99		26		28761	29918	7309
Van, Previa	'86±92	C	26		28761	29918	7309
Tacoma (w/factory man.hubs)	'95±01		26		60459		7309
Hilux Int'l with Torsion bar susp.	'98±01	C			28761	29918	7309

CUSTOM APPLICATIONS

Dana 60 axle with 35 spline outer shafts (front only)			35		62672		11714
---	--	--	----	--	-------	--	-------

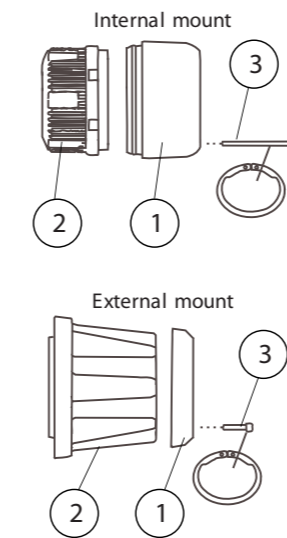

HUB SERVICE PARTS

Set PN	Std PN	Cap #y	Body #y	Hardware	Hub Service Kit	Stud Kit
6094	7277	MA	MA	MA	7302	34696
9062	9063	MA	MA	MA	7300	34696
9072	9073	MA	MA	MA	7302	34696
9790	9791	13112	13113	34594	11967	MA
11690	11689	13108	13109	35150	11714	MA
20990	20991	21526	21529	34595	20825	MA
28739	27219	MA	MA	MA	29061	38003
28751	28750	MA	MA	MA	MA	34696
28761	28760	MA	MA	MA	7309	MA
28771	28770	MA	MA	MA	7309	MA
28781	28780	MA	MA	MA	7309	MA
29062	9098	MA	MA	MA	7300	34696
29063	29907	MA	MA	MA	7302	34696
29070	29076	MA	MA	MA	39128	MA
29071	27780	MA	MA	MA	39128	MA
29087	29094	MA	MA	MA	29061	38003
29091	29092	MA	MA	MA	29061	38003
34581	34582	MA	MA	MA	7309	MA
60459	60460	MA	MA	MA	7309	MA
61424	MA	MA	MA	MA	61692	MA
61385	MA	MA	MA	MA	61693	MA
38826	38827	39384	13109	35150	11714	MA

FASTENER KITS

K for 9790 (6 screws in each kit)	34594
K for 20990 (6 screws in each kit)	34595
K for 11690 (6 screws in each kit)	35150
K for 38826 (6 screws in each kit)	35150